

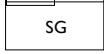











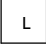
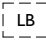
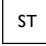

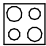

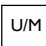
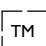
# 2 rum & kök, 55 m<sup>2</sup>

## Planritning avtalsblad

### Förklaringar

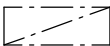
-  SKJUTDÖRRSGARDEROB
  -  KLÄDSTÅNG
  -  KLÄDSTÅNG FRONTHÄNG
  -  GARDEROB
  -  LINNESKÅP
  -  LINNESKÅP I SKJUTDÖRRS-GARDEROB/ KLÄDKAMMARE
  -  STÄDSKÅP
  -  STÄDSKÅP I SKJUTDÖRRS-GARDEROB/ KLÄDKAMMARE
  -  KYL/FRYS
  -  INDUKTIONSHÄLL OCH UGN
  -  INDUKTIONSHÄLL
  -  DISKMASKIN
  -  UGN OCH MIKRO I HÖGSKÅP
  -  TVÄTTMASKIN
  -  TORKTUMLARE
  -  KOMBIMASKIN
  -  TORKSTÄLLNING JOHN
  -  m MIKRO I VÄGGSKÅP
  -  KLÄDKAMMARE
  -  KAPPHYLLA
  -  INKLÄDNAD KANAL I TAK
  -  SCHAKT
  -  MARK, UTEPLATS OCH/ ELLER BALKONG UPPLÅTEN MED BOSTADSRÄTT
- RUMSHÖJD ca 2.5 m OM INGET ANNAT ANGES

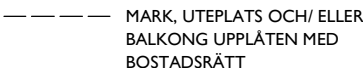
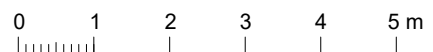
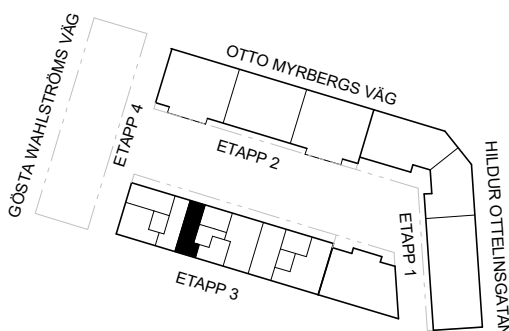
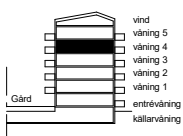
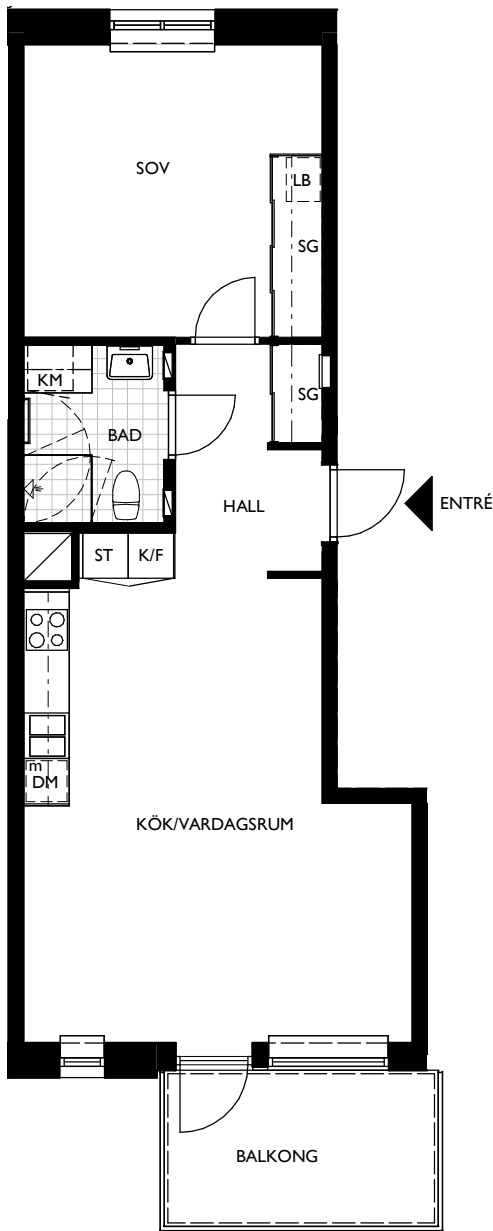

**UPPSALA**  
**BRF RICKOMBERGA BACKE 3**  
**LGH NR: 321401**

